

DAV PUBLIC SCHOOL

ROTARY CAMPUS, ASHOK NAGAR, DISTT- GAYAJI, BIHAR- 823001

Ph.No.: 0631-2950279 E-mail: davashoknagar@gmail.com. Website: davrcangaya.org

(Managed by : DAV College Managing Committee, New Delhi-55)

Ref. No.: DAV/RC.AN/Gaya/2025/ 184

Dated: 14/08/2025

TENDER NOTICE

Sealed quotations are invited from reputed and experienced firm as per the following details:

| | | |
|---|---|---|
| 1 | Name of The Works | Construction of Laboratory with Aluminum Partition |
| 2 | Estimated Area | As per estimates and Drawing |
| 3 | Approved estimated total amount | Rs. 24,73,762/- (including GST) |
| 4 | Description of Renovation / Construction work | Construction of Laboratory (Physics, Chemistry and Biology) with Aluminum Partition on Third floor of school building (Buddha Block) |
| 5 | Time of Completion | 120 Days from the issue of work order |
| 6 | Date of Tender Notification | 14/08/2025 (Thursday) |
| 7 | Last Date/Time for Receipt of Bids | 30/08/2025 (Saturday) 2.00 P.M. |
| 8 | Name and Address of office Inviting Tender | Principal, DAV Public School, Rotary Campus, Ashok Nagar, Gaya Ji, Bihar & Assistant Regional Officer, Bihar Zone-H, CRRC, Medical Road, Gaya Ji, Bihar |
| 9 | Contact Number of Procurement Office | 0631-2950279 |

FOLLOWING POINTS NEED ATENTIONS

1. Only the quality materials (Branded Company) and standard workmanship will be accepted.
2. Each interested firm will submit the two sealed quotations viz financial bid and technical bid. Please submit duly filled up mandatory proforma by tenderer.
3. The School shall not be liable to pay any tax, freight, etc. which has not been expressly stipulated in the TDS as per rule of Income Tax.
4. The undersigned does not bind himself / herself to accept the lowest quotation and reserves the right to accept the quotation in whole or in part i.e., with respect to all the articles mentioned in the attached statement or in respect of one or more than one articles specified on the attached statement as he/she may decide.
5. On acceptance of the quotation It will become a contract and the contractor shall be bounded by the terms and conditions of the quotation as well as Contractor must fulfill the terms and conditions of Government of India / State Government.
6. The quantity of articles indicated in the attached statement may be increased or decreased at the discretion of the undersigned without assigning any reason.
7. The rates quoted by the contractor shall hold good upto finishing of the renovation / construction works. No amendment will be accepted in the approved rate.
8. Rates quoted should be inclusive of all taxes, no extra charges will be paid.
9. The description of the construction details can be had from the office of the ARO Bihar Zone- H , C/O DAV Public School, CRRC, Medical Road, Gayaji, Bihar or from the Principal of DAV Public School, Rotary Campus, Ashok Nagar, Gaya Ji.
10. The payment will be made to the contractor after deduction of retention money through A/C payee cheque as per the agreement and duly approved by the Architect.
11. Quotations which do not comply with the above conditions are liable to be rejected.
12. The site proposed map, estimate and terms and condition are open for inspection before binding for all interested person.
13. All due formalities related to safety and security of the laborers (as per Government norms) is sole responsibility of the firm who will accept the work.
14. Management of wastage will be the responsibility of the firm (Contractor) and expenses will be incurred on it will be borne by the selected firm (Contractor).
15. Please note that the under-signed may change the dates or cancel the tender as well at any time without prior information

16. The payment of building Cess : Under the provision of building and other construction Workers' Welfare Cess Act, the contractor is responsible to pay building and other construction Workers' Welfare Cess, in relation to a building or other construction work to State Govt.
17. All dispute subject to Gaya Ji Jurisdiction only.

(Principal)

John 14/8/25
Principal
D.A.V. Public School
Rotary Campus, Ashok Nagar,
Gaya (Bihar)

M/S HAPPY AND ASSOCIATES

ARCHITECTS, ENGINEERS, INTERIOR DESIGNERS

Add:- Near Hindustan Press, Cotton Mill, Gaya - 823001 (Bihar)

Mob. No. 7739269750, 700467722 / Email : happyandassociate@gmail.com, Website : www.happysgroup.com

ABSTRACT COST FOR CONSTRUCTION OF LABORATORY WITH ALUMINUM PARTITION AT D.A.V PUBLIC SCHOOL, ROTARY, GAYA, BIHAR

Ref no. DAV-HA-589

Date 29/08/2024

| A | | MULTIPURPOSE ROOM CONSTRUCTION | | | | |
|----------|----------|---|----------|----------|------|---------|
| Serial | SoR | Particulars | Quantity | Rate | Unit | Amount |
| | | SHED | | | | |
| | | AREA (33' X 92') | 2970.0 | | SQFT | |
| 1 | N A | truss (33' long) (5 pc)(3.5 kg/ft) | 578 | 120 | kg | 69,360 |
| 2 | N A | rafter (33' long) (18 pc)(2kg/ft) | 1188 | 120 | kg | 142,560 |
| 3 | N A | purlins (92' long) (5 pc each) (2kg/ft) | 920 | 120 | kg | 110,400 |
| 4 | N A | PVC Shed | 276.0 | 800 | Sq m | 220,818 |
| 5 | N A | Bolts And Fastners (G.I wire, nut bolt, s-cup and fastener and lock for gate) | lumsun | | | 15,000 |
| | | WALL UPLIFTMENT | | | | |
| 6 | 6.1A | Brick work with bricks of class designation 100A in foundations and plinth in : | | | | |
| | 6.1.12/1 | Cement mortar 1 :4 (1 cement: 4 coarse sand) | | 5,017.90 | cum | |
| | 6.3A | Extra for Brick work in superstructure above plinth level upto floor V cum | | 842.20 | cum | |
| | | TOTAL COST OF 10" BRICK WORK | 35.0 | 5,860.10 | cum | 205,104 |
| 7 | 5.9 | Centring and shuttering including strutting, propping etc. and removal of form | | | | |
| | 5.9.6 | Column | 37.4 | 494.40 | Sq m | 18,491 |
| 8 | 4.2.3 | 1:2:4 (1 Cement :2 coarse sand :4 graded stone aggregate 20 mm nominal size) | 14.9 | 5,128.30 | cum | 76,412 |
| 9 | 5.22 | Reinforcement for RCC work including straightening, cutting, bending, placing in position and-binding all complete | | | | |
| | 5.22.7A | Thermo-Mechanically Treated bars TMTC-500-8mm dia. | 325.0 | 94.50 | Kg | 30,713 |
| | 5.22.7B | Thermo-Mechanically Treated bars TMTC-500-10mm dia. | 278.0 | 92.60 | Kg | 25,743 |
| FLOORING | | | | | | |
| 10 | 11.41.2 | Providing and laying vitrified floor tiles in different sizes (thickness to be specified by the manufacturer) with water absorption's less than 0.08 % and conforming to IS : 15622 of approved make in all colours and shades, laid on 20 mm thick cement mortar 1:4 (1 cement: 4 coarse sand) including grouting the joint with white cement and matching pigments etc., complete. | 276.0 | 1,638.80 | Sq m | 452,345 |
| | | Tile skirting | 11.6 | 1,638.80 | Sq M | 19,010 |

| | | ALUMINUM WORK WITH GRILL | | | | |
|----|--------|---|---------|----------|------|---------|
| | | WINDOW (6' X 5') X 12 | 360 | | SQFT | |
| 11 | 21.2.2 | Providing and fixing 12 mm thick pre-laminated particle board flat pressed three layer or graded wood particle board conforming to IS: 12823 Grade I Type II, in panelling fixed in aluminium doors, windows shutters and partition frames with C.P. brass / stainless steel screws etc. complete as per architectural drawings and directions of engineer-in-charge. Pre-laminated particle board with decorative lamination on both sides | 33.5 | 826.90 | Sq m | 27,666 |
| 12 | 21.3.2 | Providing and fixing glazing in aluminium door, window, ventilator shutters and partitions etc. with EPDM rubber / neoprene gasket etc. complete as per the architectural drawings and the directions of engineer-in-charge. (Cost of aluminium snap beading shall be paid in basic item): With float glass panes of 5.50 mm thickness (weight not less than 12.50 kg/sqm) | 33.5 | 1,115.10 | sqm | 37,308 |
| 13 | N A | Miscellaneous items and other fitting and fixture charge for silicon lining, clips and claps | 12.0 | 1,200 | EACH | 14,400 |
| 14 | MR | Providing and fixing M.S. grills of required pattern in frames of windows etc. with M.S. flats, square or round bars etc. all complete. Fixed to openings/wooden frames (1.5 kg/sqft) | 540.0 | 120.00 | kg | 64,800 |
| | | FALSE CEILING | 2,970.0 | | SQFT | |
| 15 | 12.82 | Providing and fixing at all height false ceiling of 12.5 mm thick -tapered edge gypsum board conforming to IS : 2095 including - providing and fixing as per specification and mention in SOR. (EXCLUDING PAINTING) | 276.0 | 738.30 | Sq m | 203,787 |
| 16 | NA | LED AT LIGHT POINTS (UNIT WISE) (inclusive of wire and wiring) | 83.0 | 1,600.00 | each | 132,800 |
| 17 | NA | Diffused light of approximate length (desired colour and brand) * | 76.2 | 450.00 | m | 34,290 |
| 18 | NA | Electrical work and fittings per light | 83.0 | 2,500.00 | each | 207,500 |
| 19 | NA | fixtures like switch board and other miscellaneous | lumsun | | | 20,000 |

| PLASTER AND PAINTING | | | | | | |
|----------------------|-----------|---|-------|--------|------|-----------|
| 20 | 13.11.1 | Cement plaster in course sand 12 mm cement plaster of mix: 1:3 (1 cement:3 coarse sand) | 242.0 | 164.30 | SQM | 39,761 |
| 21 | 13.80 A.1 | Providing and applying white cement based putty of average thickness 1 mm, of approved brand and manufacturer, over the plastered wall surface to prepare the surface even and smooth complete. | 242 | 81.1 | sqm | 19,626 |
| 22 | 13.92 | Wall painting with plastic emulsion paint of approved brand and manufacture to give an even shade: | | | | |
| | 13.92.1 | two or more coats | 518 | Sq M | 86.4 | 44757 |
| TOTAL (A) | | | | | | 2,128,506 |
| rate per sqft | | | | | | 717 |

| B ALUMINUM PARTITION WORK | | | | | | |
|-----------------------------------|--------|---|-------|----------|------|---------|
| TOTAL PARTITION AREA (115' x 12') | | | 1380 | | SQFT | |
| 1 | 21.2.2 | Providing and fixing 12 mm thick pre-laminated particle board flat pressed three layer or graded wood particle board conforming to IS: 12823 Grade I Type II, in panelling fixed in aluminium doors, windows shutters and partition frames with C.P. brass / stainless steel screws etc. complete as per architectural drawings and directions of engineer-in-charge. Pre-laminated particle board with decorative lamination on both sides | 128.3 | 826.90 | Sq m | 106,052 |
| 2 | 21.3.2 | Providing and fixing glazing in aluminium door, window, ventilator shutters and partitions etc. with EPDM rubber / neoprene gasket etc. complete as per the architectural drawings and the directions of engineer-in-charge. (Cost of aluminium snap beading shall be paid in basic item); With float glass panes of 5.50 mm thickness (weight not less than 12.50 kg/sqm) | 128.3 | 1,115.10 | sqm | 143,015 |
| 3 | N A | Miscellaneous items and other fitting and fixture charge for silicon lining, clips and claps | 128.3 | 750.00 | sqm | 96,190 |
| TOTAL (B) | | | | | | 345,257 |
| rate per sqft | | | | | | 250 |

| | | | AREA (SQFT) | RATE PER SQFT | TOTAL |
|--------------------|---|--------------------------------|-------------|---------------|-----------|
| 1 | A | MULTIPURPOSE ROOM CONSTRUCTION | 2,970.0 | 717 | 2,128,506 |
| 2 | B | ALUMINUM PARTITION WORK | 1,380.0 | 250 | 345,257 |
| TOTAL COST | | | | | 2,473,762 |
| TOTAL RATE OF WORK | | | Rs./Sqft | | 833 |

SAY TOTAL - 24,73,762/- ONLY

TWENTY FOUR LAKH SEVENTY THREE THOUSAND SEVEN HUNDRED SIXTY TWO ONLY

Note: Rates are inclusive of GST.

HAPPY & ASSOCIATES

29/03/2024

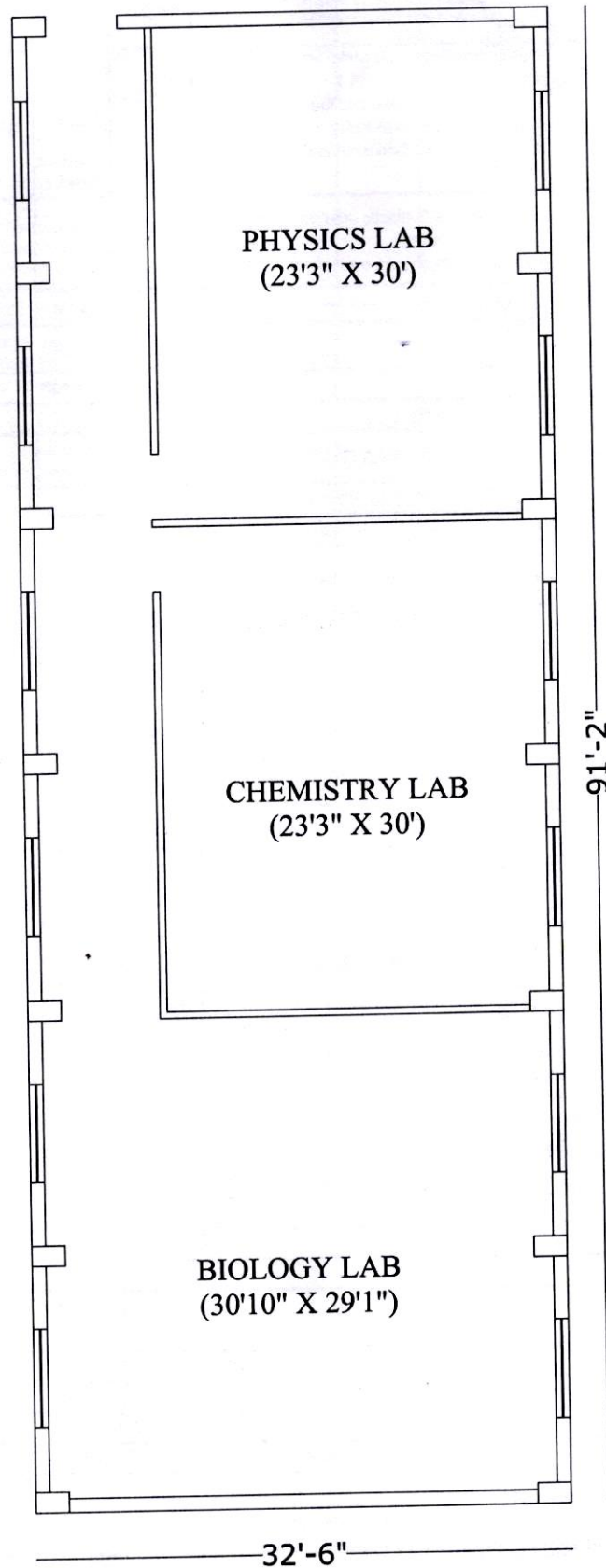

| | | |
|----------|------------------------------------|---|
| PROJECT: | DAV PUBLIC SCHOOL ROTARY CAMPUS | ARCHITECTS HAPPY&ASSOCIATES Add:- Near Hindustan Press, Cotton Mill, Gaya - 823001 (Bihar) Mob. No. 7739269750, 700467722 / Email : happyandassociate@gmail.com, Website : www.happysgroup.com |
| TITLE | LABORATORIES ON TERRACE (PLAN) | |